

## Sensing

# Obstacle Course Challenge

### Challenge Description

This challenge includes obstacles which forces students to use sensors in order to get to the goal area. The robot must first begin at the starting area, touch the wall, follow a line, get to the calibration area using the Sonar, Touch, or Light sensor, and finally getting to the goal.

### Materials Needed

- Black electrical tape
- Red electrical tape
- Scissors (or cutting tool)
- Ruler (or straight edge)
- 3 Styrofoam cups
- 4 Books
- 1 LEGO Box container

### Board Specifications

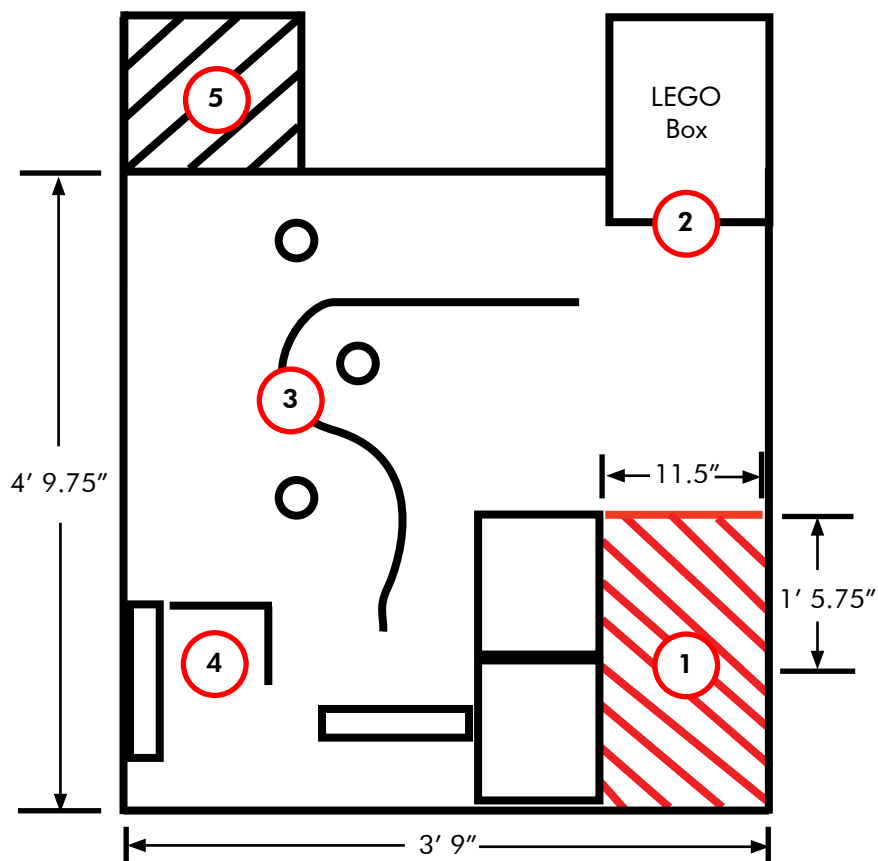

Note: Diagrams are not drawn to scale

- 1** Starting area.
- 2** Touch the box.
- 3** Follow the line while avoiding obstacles.
- 4** Get to this calibration area.
- 5** Goal area.